

LANDSCAPE IRRIGATION PLAN  
 TCR, THE VAUX

SCALE: 1/8" = 1'-0"

MANAGER: MARK B. DEY.  
 DRAWN BY: DCY.

This drawing is schematic representation only and is not intended to be used for construction without the approval of the engineer. The engineer's approval is not a warranty or a guarantee of the accuracy of the information provided. The engineer's approval is based on the information provided and does not constitute a warranty or a guarantee of the accuracy of the information provided.

DATE: 6-24-2006  
 RE: 2-23-2007

PAGE NUMBER: 1 OF 1  
 PLAN NUMBER:

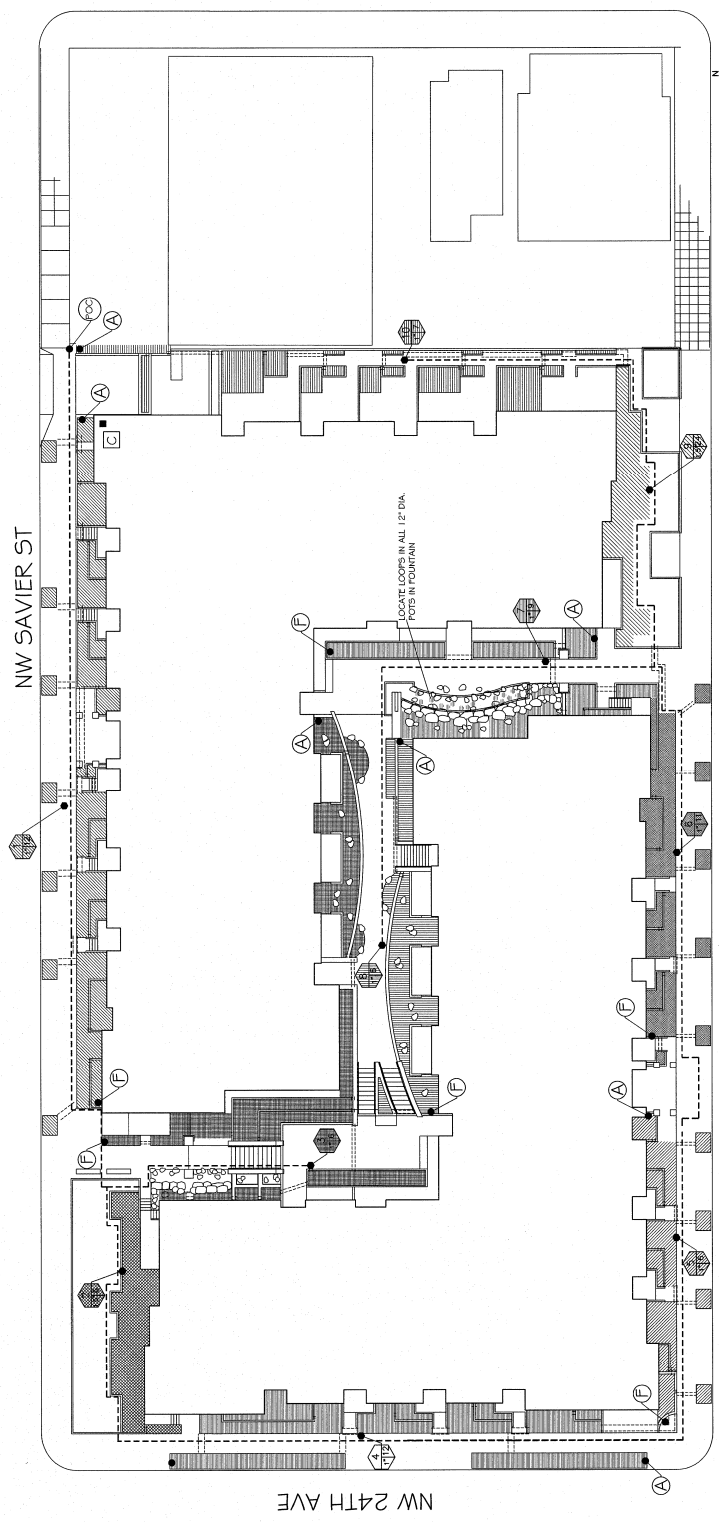

IRRIGATION LEGEND

- IRRIGATION CONTROL VALVES
- NUMBERED-100B-COM
- AIR RELIEF VALVES
- LC-09-1.0 DRIP TUBING
- POINT OF CONNECTION
- CONTROL
- MANUAL FLUSH VALVES
- MANIFOLDS SCH 40/SCH 80
- SLEEVES CLASS 200
- PVC PIPES SCH 40/80
- INDICATES CONTROL VALVE NUMBERS
- INDICATES GALLON PER MINUTE
- INDICATES VALVE SIZE

IRRIGATION GENERAL NOTES:

1. INSTALL IRRIGATION SYSTEM IN ACCORDANCE WITH ALL LOCAL CODES AND ORDINANCES.
2. IRRIGATION PLANS ARE SCHEMATIC. ALL IRRIGATION EQUIPMENT SHALL BE PLACED IN ACCORDANCE WITH THE FIELD CONDITIONS. THE FIELD CONDITIONS SHALL BE CHECKED WHEREVER POSSIBLE. FIELD ADJUST LINES TO AVOID CONFLICT WITH UTILITIES.
3. SYSTEM IS DESIGNED TO OPERATE WITH A PRESSURE WITH A MIN. 75 GPM AT POINT OF CONNECTION. HEAD LAYOUT AND ZONES ARE BASED ON THIS DATE AND SHOWN IN CONNECTION HEAD KEY.
4. SLEEVING TO BE TWICE THE DIAMETER OF THE PIPING IT CONTAINS.